

IMPRESSION
394 | 444 | 494



elan

WWW.ELAN-YACHTS.COM

ELAN Yachts

IMPRESSION

A new generation of blue water cruisers with raised deck saloon for generous volume and numerous innovative layouts offering comfort and safety on deck as well as below.



Designed by Humphreys Design Studio and Elan Design Team Impression yachts are built for pleasurable cruising with a high level of comfort onboard and easy handling for a short-handed crew in mind. Combining Rob Humphreys' hull design with an optimal rig and sail area we ensured maximum stability and safety of all Impression yachts in ever demanding sea conditions. Elan Impression yachts are available with twin wheels for maximum control

and comfort in the cockpit. Impression 494 offers twin rudders for maximum control in extreme sailing conditions. All Elan Impression yachts offer generous volume below deck with plenty of space and natural light thanks to the raised decksaloon layout and numerous sky hatches and portholes. Designed for cruising, Elan Impression Yachts constantly set new standards in comfort and performance in the cruiser section.



ELAN IMPRESSION 394
page 12

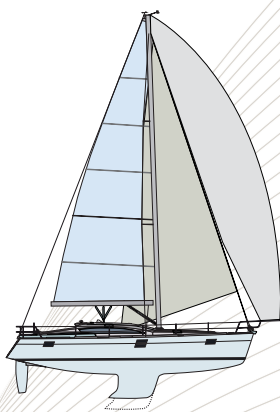

ELAN IMPRESSION 444
page 22

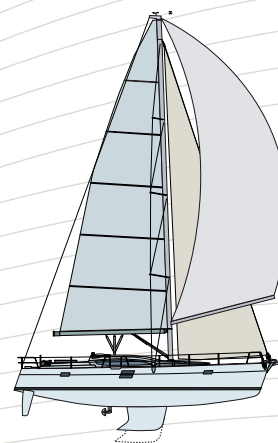

ELAN IMPRESSION 494
page 34

ABOUT ELAN YACHTS





1949



1962



1980

Elan is a global producer and supplier of sports and leisure time activities equipment with its origins in Slovenia. The company, established in 1945, has a proud long history in the market. **All Elan's enterprises are devoted to technical development of products and progressive design through innovative approach and advanced technology.** The combination of these elements provides the ultimate sporting pleasure to our customers around the world. The Winter division at Elan manufactures **skis and snowboards**, the Marine division produces **sailing yachts**, while Elan Inventa is the leading brand in central Europe and the Balkans providing **sports facilities** with all necessary equipment. In 2010 Elan commenced cooperation

with a major **wind power producer**; a program to be a part of the alternative energy division. All Elan's production facilities are located in central Europe with skis and yachts, produced in Slovenia. Elan owns five companies, in the USA, Canada, Germany & Austria, Switzerland and Japan. Elan continues to develop superior products and Elan brand from its headquarters in Begunje na Gorenjskem, in the heart of northern Slovenia. The company is the strongest and most global Slovene brand and the pride of the Slovene people and its employees. Elan is not only in the heart of Slovenia but also in the hearts of many people using Elan products around the world in more than 60 countries on all continents.

More than 60 years of experience

Elan's boatbuilding tradition began in 1949 with kayaks, canoes and small boat production made of waterproof wooden slabs. Early commercial success came in the 1950s when a large number of small crafts were exported to the United States. **The Sixties heralded the dawn of reinforced polyester, a revolutionary material that Elan used for racing kayaks and boats.** The following decade the yard launched the first sailboats and the most successful small vessel selling 10,000 units in the following years. **The 1980s were synonymous with a significant shift towards the production of larger cruiser-racer sailing yachts**, designed by the now J&J Design studio, including the legendary Elan 31, which won the Quarter Ton World Championship

with Dušan Puh. **In 1995 Elan commenced cooperation with the renowned nautical designer, Rob Humphreys, resulting in many successful, award-winning projects.** In the next decade Elan won European Yacht of the Year title twice, for the Impression 344 and 340 models. Not resting on its laurels, Elan launched the revolutionary Volvo Ocean Race inspired Elan 350 with characteristic chines and twin rudders, winning another European Yacht of the Year title in 2011, a nomination for Elan 210 the following year, and Elan 400 nomination for 2014. Building on rich tradition, combined with an innovative present, Elan is laying strong foundations for the future.



ELAN IMPRESSION 344



ELAN 340



ELAN IMPRESSION 514



ELAN 410



ELAN 350



ELAN 210



ELAN 400

HOW WE BUILD OUR BOATS

The Elan and Impression ranges embody a true passion for sailing, technological innovations and distinctive design. Every yacht coming from Elan's 16.000 sq meter boatyard in Slovenia is the result of our 65-year long passion for innovation-oriented quality boatbuilding.





Elan is the only production boatbuilder that uses exclusively VAIL and 3D VAIL technology and its benefits.

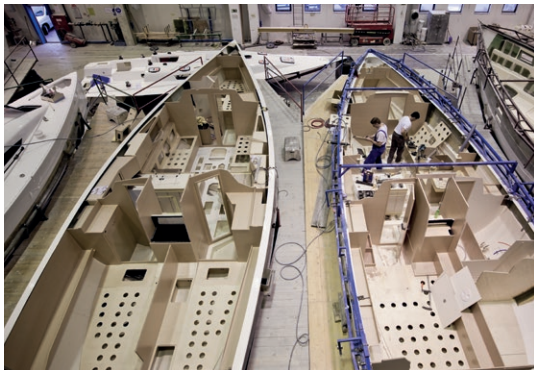

Latest technologies and modern interior design make Elan Yachts leaders and trend setters in every aspect.



Your yacht is built by our highly skilled craftsmen with great care and attention to every detail.



We want to make sure that your yacht is in perfect condition when she is delivered to you so every Elan yacht goes through a testing process in our test tank before departure from the yard.



Certified by Germanischer Lloyd, our yachts are designed to withstand the toughest conditions, while bringing every owner pure sailing pleasure and excitement. Elan is

committed to a comprehensive environmental management system, minimizing our impact on nature, proven by the ISO 14001 standard for an environmentally friendly production.

HUMPHREYS YACHT DESIGN



Founded in 1974, Humphreys Yacht Design's roots lie in the design of racing yachts and small custom sailing yachts, but over the years the HYD has expanded into the production and large custom sectors for both sailing and motor yachts – yet still without forsaking what for years has been its core business. Indeed, the diversity of projects undertaken creates a fertile crossflow of thinking and helps to maintain HYD's standing at the cutting edge of yacht design, keeping ideas fresh and allowing skills and knowledge from one area of the design spectrum to filter across into others.



Humphreys Yacht Design have been principal designers for Elan Marine since the mid 1990s, working with Elan's own extensive in-house engineering team. When, with the Balkan troubles of the eighties and early nineties, Elan was forced to look to Europe for their market they chose Rob Humphreys to design the Elan 295, and from that first relationship it has been an ever-strengthening tie. Rob Humphreys has consistently helped direct the company's vision, with a range of boats that offer excellent racer-cruiser balance. It's what Humphreys has frequently referred to as the 60/60 range, where the racing eye will focus on the boats' obvious race-winning potential and feel the designs are biased in his direction, while the more cruisy temperament will see his own particular interest as being the one that commands the 60%.

The Elan range is a series of resilient cruising with racing yachts that appeals to professional and amateur sailing crews as well as families who love to holiday on the water. It combines modern technology and expertise with a respect for tradition, elegance and stylish good looks. All the yachts in the series are designed for fast passage-making, regattas and other racing events, but at the same time they are styled with comfort and safety in mind so that sailing companions — whether experienced or apprentice — can enjoy both the ride and the destination. For some owners, an Elan is a first yacht or a stepping stone, while for others it is all they ever wished for. Elan also offer the Impression range, a more dedicated cruising line also designed by the Humphreys team. Despite a very impressive turn of speed these boats are designed essentially for comfort and a cruising feel-good factor, and the range has been a huge success for the company.

The Elan/Humphreys team consistently strives to explore new developments and respond to feedback from owners, so that if an owner wants to race he can win, and if he wants to cruise then he will be able to do so in a reassuring fashion, content in the knowledge that he can reel away the miles in comfort. This approach has won the brand a high level of customer loyalty which in turn translates into a motivated and passionate design team.

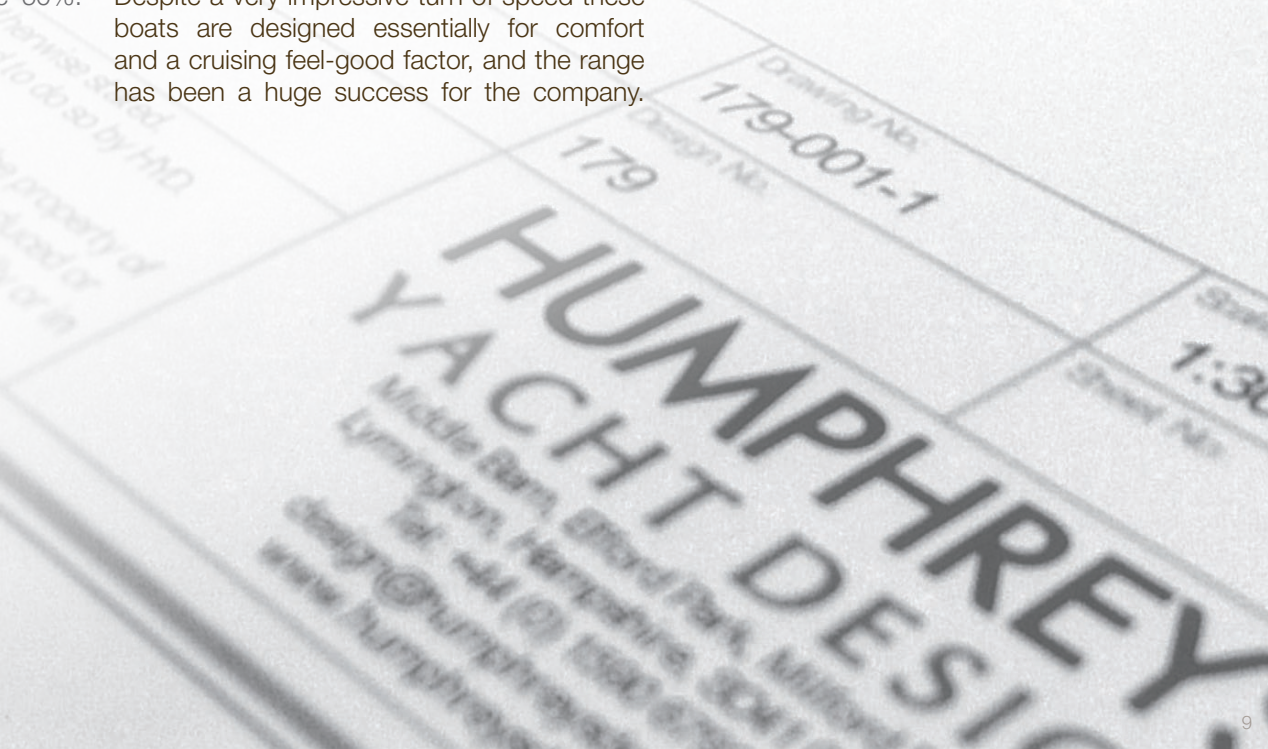

COMFORT FEATURES AND SAFETY!

The Impression range sets new standards in safety and comfort onboard. With a raised deck saloon they offer the largest volume in class and each model has numerous interior layouts to suit even the most demanding yachtsmen. The innovative inverted saloon ensures the optimal

use of maximum width of the yacht without compromising at cabin and galley dimensions and the number of head compartments. At Elan we listen to our customers and try to accommodate their wishes beyond standards we offer and customise our yachts for each and every client to best suit their wishes.



DECK SALOON VOLUME

The deck-saloon layout provides extra volume in comparison to traditional designs as a bigger beam is available and put to good use.

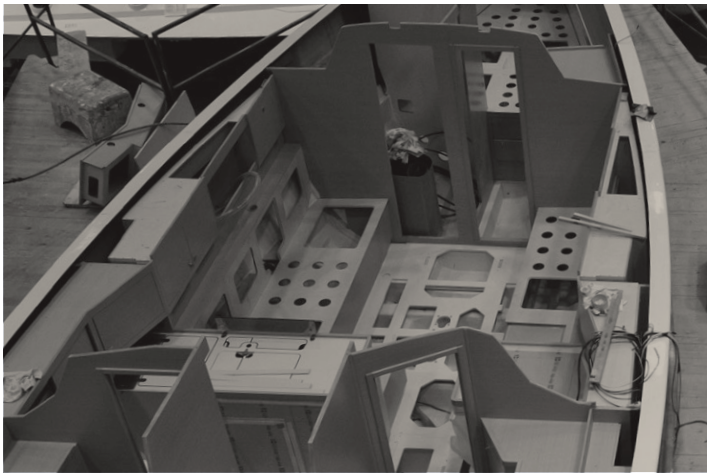

DSI - DECK SALOON INVERTED

We inverted the layout and put the saloon forward of the companionway, so the social area is located at full beam.



VAIL

VACUUM ASSISTED INFUSION LAMINATION

The 3D VAIL technology brings better load-carrying capacity, increased hull strength and reduces the risk of osmosis.



SHORT-HANDED SAILING

Short-handed solutions improve the yacht's safety and comfort, easily operated by limited crew.



INTEGRATED GANGWAY

The gangway is integrated in the yacht's transom which adds simplicity to life aboard and is ready to deploy or store in no time.

SELF-TACKING JIB

A comfortable solution, designed for short-handed crews, brings easy manoeuvring in any weather conditions.



TWIN-WHEEL TWIN-RUDDER SYSTEM

The VOR inspired solution ensures better control and handling even in extreme conditions.

ELAN IMPRESSION 394

FAMILY COMFORT

“This impressive sailing yacht is designed to satisfy even the most demanding cruising families, friends or couples who really appreciate distinctive design, style and comfort. Her welcoming semi-deck saloon is awash with natural light soaking through the panoramic windows, while the light-wood interior conveys a contemporary look & feel. Despite the interior that offers about 25% more internal volume than many of its immediate competitors the yacht returns exceptional seaworthiness and robust construction for its class. The Elan Impression 394 is set to provide years and years of satisfaction to her owners.”

Rob Humphreys



- 
- A photograph of a sailboat on a blue sea. The sailboat has a large white sail that is partially visible. A person is sitting on the edge of the boat, looking out at the water. The sky is clear and blue. The boat is white with a dark hull. The water is a deep blue with some whitecaps. The overall scene is peaceful and scenic.
- EXTRA VOLUME
 - SWIM PLATFORM
 - EASY HANDLING

A fast blue water cruiser, offering a superb level of comfort for weeks of delight and pleasure at sea.

EXTERIORS

In line with Elan's commitment to deliver the best sailing experience with every model, every time, the new Elan Impression 394 is an impressively fast cruiser. Designed and engineered to deliver serious fun time for everyone aboard, the yacht is a cruising delight. Leaving no room for compromise between performance and comfort, the new Elan Impression 394 draws from Elan's rich history and experience in performance-oriented boatbuilding.

Everything aboard the Elan Impression 394 is well-thought out to ensure a pleasurable experience, whether under sail cruising or when reveling in picturesque secluded bays at anchor.

The spacious cockpit with large, protected sitting areas and the fixed cockpit table provide superior comfort for crew and visitors, while the large sunbathing deck forward will be everyone's delight. The twin steering wheel arrangement offers an ideal position for the helmsman, while the wide transom and bathing platform ensure easy access to the sea.



The cockpit is well protected from sprays by high cockpit sidewalls, which in turn ensure more safety for the younger crew.



GPS mount as an option at the steering console for direct control over your heading.

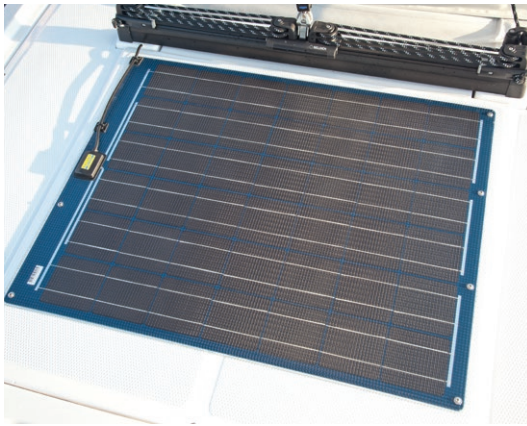

A solar panel can be mounted on the cabin roof in order to ensure enough power even on longer cruising hauls. Available as an option.



The drop-down bathing platform offers easy access to the sea, while increasing the surface area on deck.

Spacious and comfortable cockpit with a fixed cockpit table and easy access to the folding swim platform.





The fixed bowsprit ensures easy downwind sailing.



Bow cushions for enjoyable cruising.





Thanks to the swim platform, the cockpit area is larger and more comfortable and access to the sea is at hand.

INTERIORS

The interior is spacious and airy, with abundant natural light coming from various expansive coachroof and hull windows, thanks to its deck-saloon setup. Designed according to the latest trends, the interior offers supreme comfort and ensures a delightful sojourn on-board. The saloon features a large settee on starboard and another on portside a generous L-shaped galley to satisfy even the most demanding on-board cooks and a functional nav station for comfortable navigation. Accommodation aboard the Elan Impression 394 is supremely comfortable, with spacious cabins fore and aft. The bright fore cabin now comes with easier access to the double berth from the side, combined with more storage space. The aft cabins are generous as well, with plenty of light coming from the hull and deck windows. Available in four different layouts, a 2-cabin with single or double head compartments and a 3-cabin version with single or double head compartments, as well, accommodating four or six respectively.





Functional L-shaped galley.



Double size saloon table that folds down and creates additional berth in the saloon.



The saloon features an innovative flip-up navigation table transforming into a settee or a berth.

Plenty of storage space with a comfortable double berth.



Head compartment is spacious and bright with a separate shower stall.

TECHNICAL SPECIFICATIONS

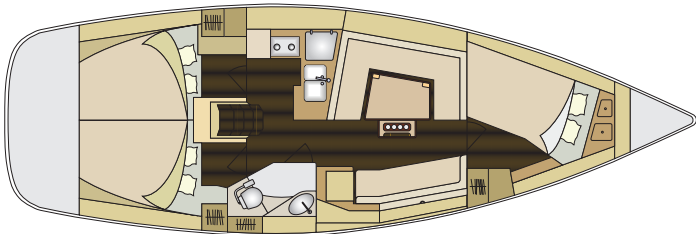

3 cabins / 1 head

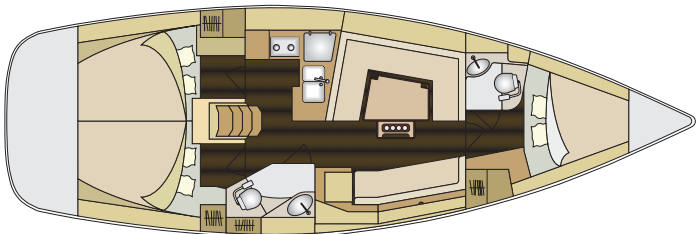

3 cabins / 2 heads

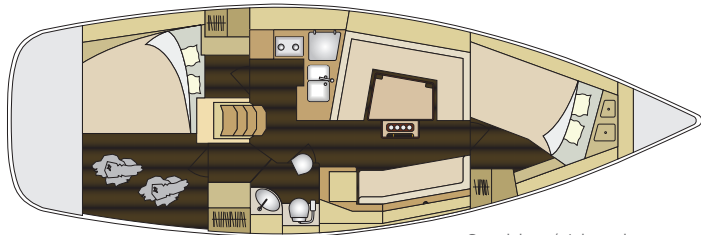

2 cabins / 1 head

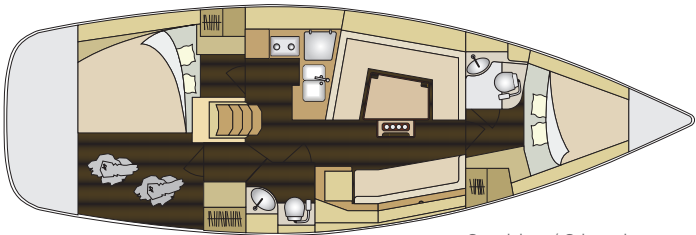

2 cabins / 2 heads

LENGTH OVERALL	11.90 m
HULL LENGTH	11.48 m
LENGTH AT WATERLINE	10.01 m
BEAM MAX	3.91 m
DRAFT	1.50 m / 1.80 m
AIR DRAFT (incl. 1 m antenna)	17.44 m
DISPLACEMENT	8.000 kg
BALLAST	2.478 kg / 2.545 kg
ENGINE POWER MAX	28,4 kW / 39.6 hp
FUEL CAPACITY	165 liters
WATER CAPACITY	240 liters / 272 liters

MAXIMUM CREW	8 persons
MAINSAIL	37.91 m ²
GENOA	38.11 m ²
SPINNAKER	98.00 m ²
GENNAKER	89.83 m ²
I	13.96 m
J	3.90 m
P	13.00 m
E	4.86 m
DESIGN	Humphreys Yacht Design & Elan design team



POLAR DIAGRAM

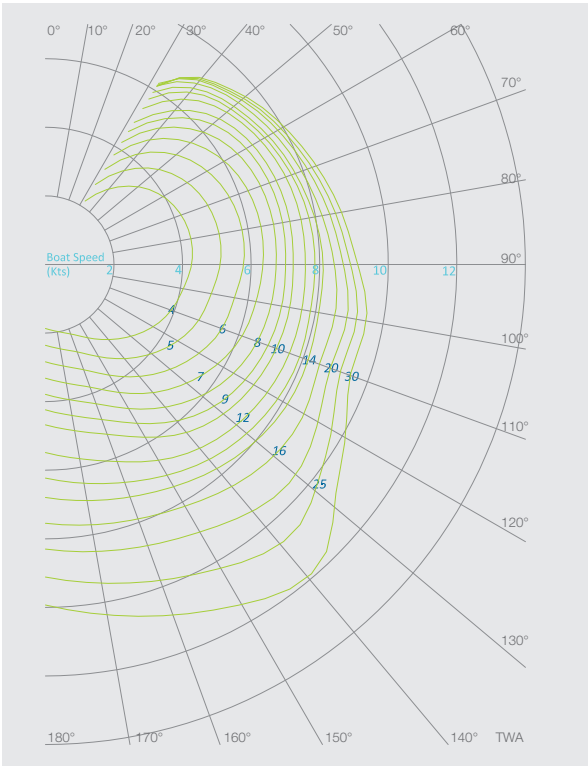

STABILITY CURVE

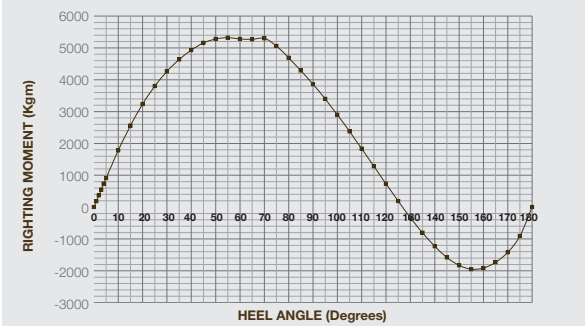

STANDARD

- 

L-SHAPED KEEL
- 

SINGLE RUDDER
- 

TWIN WHEELS
- 

VAIL
HULL INFUSION
- 

CLOSED COCKPIT
- 

COCKPIT TABLE
- 

FOLDING PLATFORM

OPTIONALS

- 

ANCHOR WINCH
- 

BOW THRUSTER
- 

POLE FOR SPINNAKER
- 

IN-MAST FURLING
- 

SELF TACKER

ELAN IMPRESSION 444

MULTIDIMENSIONAL CRUISER

"The Elan Impression 444 is in every way an impressive sailing yacht. Developed to satisfy the needs of every family member, it will be the joy of family cruising vacations, whether it is in the Mediterranean, the Caribbean or on a blue water crossing. Built to ensure maximum comfort, anytime, it is extremely enjoyable to sail as well, as performance is always an important feature on every sailing boat coming out of Elan."

Rob Humphreys



- 
- 4- CABIN INTERIOR LAYOUT
 - COMFORTABLE COCKPIT
 - SAFE AND EASY SAILING

A true long distance bluewater cruiser.
Safety and seaworthiness in comfort
and style.

EXTERIORS

Life is always good aboard the Elan Impression 444. Every detail made to ensure an enjoyable and safe journey, from the spacious cockpit with large sitting areas all around the cockpit table, to the large passageway forward, where plenty of space for sunbathing awaits. The twin steering wheel arrangement offers an excellent position for the helmsman, while the wide transom ensures easy access to a sea of adventures. To ensure enough energy on longer hauls, we offer the installation of solar panels, as an option.





Easy and safe access down below and an additional seat at the large cockpit table.



Navigation electronics and audio remote close at hand for the helmsman.



Plenty of space inside the cockpit table and stainless steel grabrail for safer movement in the cockpit.

Comfortable helmsman seats and a safe passage astern to the folding swim platform.





Easy lifting system for the swim platform in the sorage under the starboard helmsman seat.



Teak cupholders near at hand for the helmsman as well as the crew seated around the cockpit table.



Comfortable swim platform with safe passage into the cockpit and cockpit shower.



INTERIORS

The journey in style continues below deck, with an airy interior, clean lines and plenty of natural light coming from various deck and hull windows. Designed as a semi deck-saloon, the Elan Impression 444 features a large settee around the saloon table on portside and another settee on starboard. With the saloon table enlarged, it accommodates comfortably the crew and even a few visitors. The saloon offers plenty of space where children can play and the generous galley will cater for the most demanding chefs. Two spacious head compartments are featured in all layouts.





Storage is generous around the galley and saloon, with well thought out solutions for storing fruit, bottles and other galley appliances.

Nav station features ample space for paper charts storage under the large navigation table.

Functional L-shaped galley.





Luxurious owner's forecabin features a large double berth, lots of storage and plenty of natural light coming from the deck hatch and two hull windows.



Spacious aft cabins feature double berths and a settee with plenty of wardrobe space and three portholes for fresh air and natural light.



Aft head features a separate shower, electric flushing toilet as an option and plenty of storage.

TECHNICAL SPECIFICATIONS

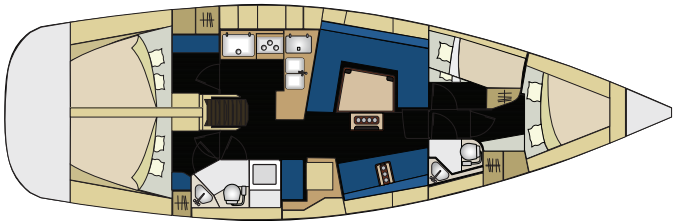

4 cabins / 2 heads

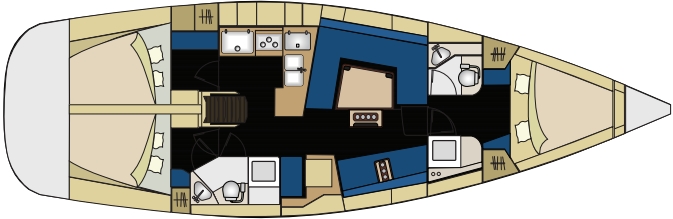

3 cabins / 2 heads

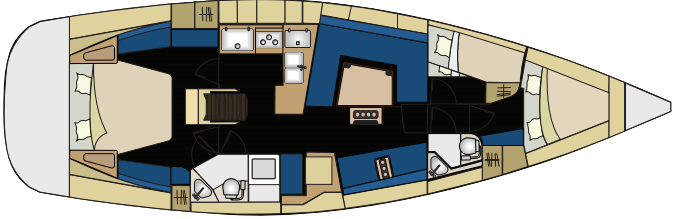

2 cabins / 2 heads

LENGTH OVERALL	13.85 m
HULL LENGTH	13.00 m
BEAM	4.18 m
DRAFT	1.60 m / 1.90 m
DISPLACEMENT	10.900 kg
BALLAST	3.460 kg / 3.320 kg
ENGINE	41 kW / 55 hp
FUEL CAPACITY	230 liters
WATER CAPACITY	272 liters / 516 liters

AIR DRAFT	19,25 m
MAINSAIL	46.47 m ²
GENOA	52.47 m ²
GENNAKER	135.45 m ²
I	15.90 m
J	4.78 m
P	14.80 m
E	5.35 m
BOAT DESIGN CATEGORY CE	A
DESIGN	Humphreys Yacht Design & Elan design team



POLAR DIAGRAM

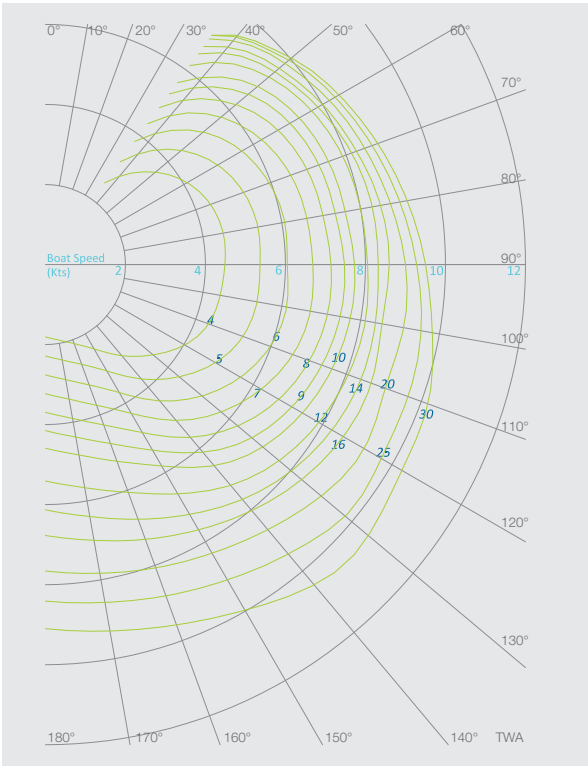

STABILITY CURVE

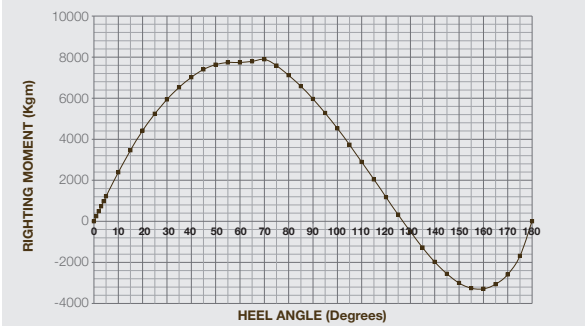

STANDARD

- 

L-SHAPED KEEL
- 

SINGLE RUDDER
- 

TWIN WHEELS
- 

HULL INFUSION
- 

CLOSED COCKPIT
- 

COCKPIT TABLE
- 

FOLDING PLATFORM

OPTIONALS

- 

ANCHOR WINCH
- 

BOW THRUSTER
- 

POLE FOR SPINNAKER
- 

IN-MAST FURLING
- 

SELF TACKER

ELAN IMPRESSION 494

OPEN SPACE EXPLORER

"The yacht delivers a consistently pleasurable sailing experience, which means fast cruising and easy handling, even when short-handed. We combined our hull design with an optimal rig and sail area, ensuring the yacht is stable and safe in every sea condition, yet with a very high pointing ability without sacrificing downwind performance. Another strong feature includes the twin wheel - twin rudder system, which ensures better control and handling even in extreme conditions, a self-tacking jib system, a through-deck furling genoa and furling gennaker as an option. All sheets run all the way to the steering position, which allows the helmsman to trim the sails himself, using two winches directly in front of the steering wheels."

Rob Humphreys



- 
- An aerial photograph of a sailboat, likely a Beneteau Impression 494, sailing on a deep blue sea. The boat's deck is finished with light-colored teak planking. A large, white, rectangular canvas cover is positioned on the deck near the mast. The mast is white and has various rigging lines and blocks attached. The boat's hull is white, and the water around it shows some white foam from the wake. The sky is not visible, as the image is focused on the boat and the sea.
- 5+1 CABIN INTERIOR
 - DECK SALOON INVERTED
 - OPEN AFT WITH A LARGE PLATFORM

The Impression 494 embodies what long distance luxury yachts represent.

EXTERIORS

ELAN·IMPRESSION·494

Untangle, unwind and revel in the great outdoors. Discover an unprecedented level of comfort for days of enjoyment in the sun on the largest cockpit in its class, featuring longer U-shaped cockpit seats 2,1 m in length and a foward sun bed. Find a secluded bay and access the immaculate sea easily through the electrically operated swimming platform. And while there, serve yourself a crisp cold drink right from the cockpit fridge and outside bar and revel in the spectacular view and enjoy every detail, designed to live unforgettable moments aboard, when sailing or at anchor.





All sheets are running back to the helmsman's steering position, making sail trimming simple and accessible.



The liferaft can be stored near the helm, on the port side.



The large, electrically operated swimming platform ensures easy access to the sea and uncovers the spacious transom storage.



Cold drinks are always in reach at the cockpit bar, featuring a fridge and optionally even a sink in the outside galley.





Twin rudders ensure better control and handling even in extreme conditions.



INTERIORS

The interior welcomes you with plenty of space and natural light, thanks to the raised deck-saloon layout, numerous hull windows and portlights. Enjoy the open space social area, courtesy of the inverted layout, with the galley forward and the large open plan saloon located directly under the companionway, taking advantage of the yacht's full beam. Celebrate life with friends and family around the spacious saloon with a U-shaped settee and two additional seats. Step down to the roomy, functional galley and navigation station or discover the comfortable, stylish cabins.





Inverted layout provides the largest saloon possible.



Adaptable saloon table transforms into a very comfortable double berth.

Functional U-shaped galley provides more comfort and safety when cooking while sailing or motoring.



Nav station features the media corner and various storage spaces.



Twin fore cabins provide a large double berth, storage and plenty of natural light.



Crew cabin with comfortable bunk berths for additional guests onboard.



TECHNICAL SPECIFICATIONS

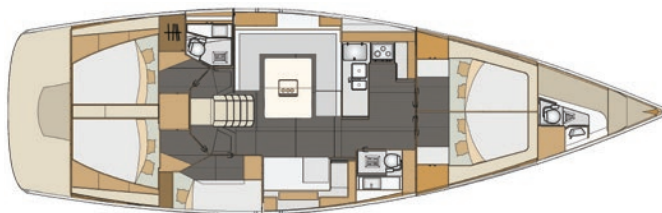

5 cabins + 1 / 3 heads

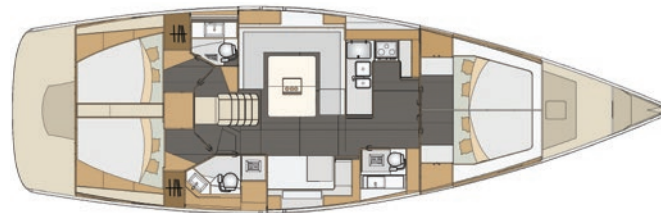

4 cabins / 3 heads

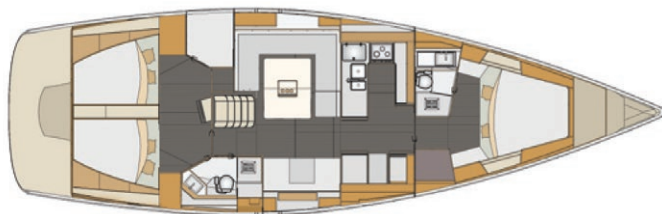

3 cabins / 2 heads

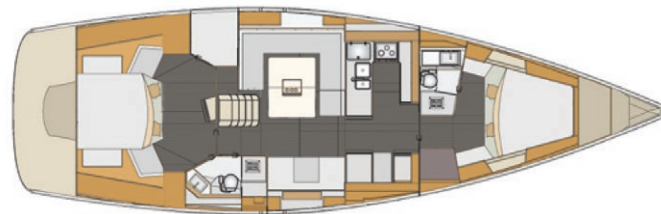

2 cabins / 2 heads

LENGTH OVERALL	14.90 m
HULL LENGTH	14.85 m
LENGTH AT WATERLINE	13.76 m
BEAM MAX	4.68 m
BWL MAX	4.04 m
DRAFT	2.23 m / 1.80 m
DISPLACEMENT	app. 14.500 kg
BALLAST	4.500 kg
ENGINE POWER MAX	55 kW / 75 hp
FUEL CAPACITY	295 liters
WATER CAPACITY	605 liters

MAXIMUM CREW	12 persons
BERTHS	4 + 1 - 12 + 1
MAINSAIL	67,06 m ²
GENOA	49,22 m ²
SPINNAKER	127.00 m ²
I	18.74 m
J	5.25 m
P	17.90 m
E	6.25 m
INTERIOR DESIGN	Gigodesign
DESIGN	Humphreys Yacht Design & Elan design team

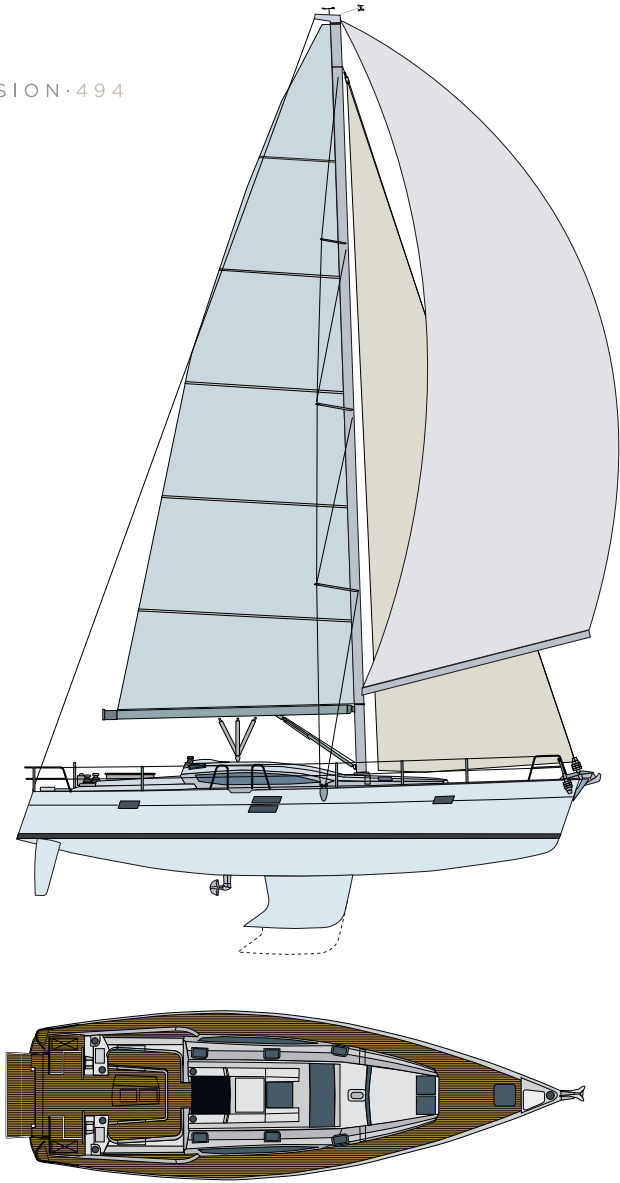

POLAR DIAGRAM

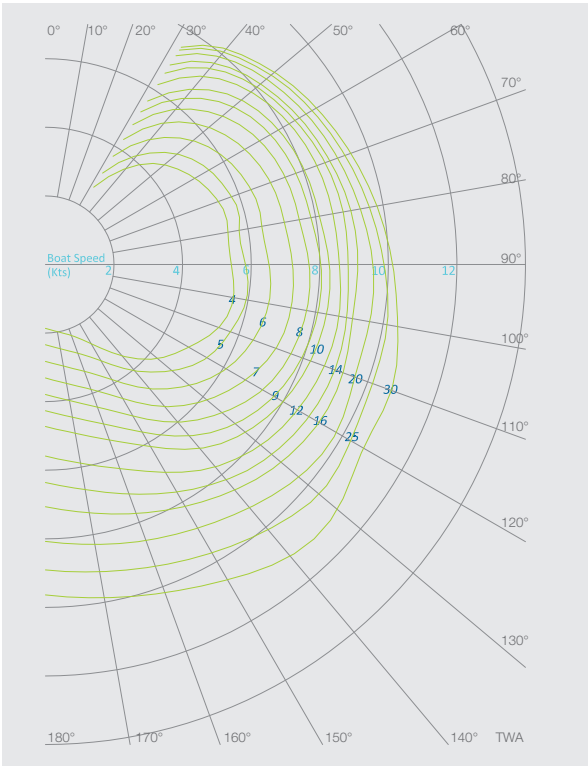

STABILITY CURVE

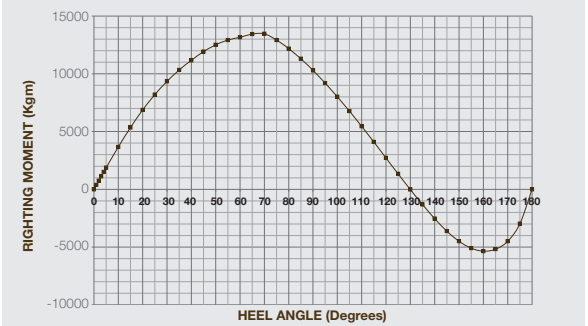

STANDARD

- 

L-SHAPED KEEL
- 

TWIN RUDDERS
- 

TWIN WHEELS
- 

VAIL
HULL INFUSION
- 

3D VAIL
3D INFUSION
- 

FOLDING PLATFORM
- 

COCKPIT TABLE
- 

SELF TACKER
- 

ANCHOR WINCH
- 

OPEN COCKPIT

OPTIONALS

- 

GANGWAY
- 

BOW THRUSTER
- 

POLE FOR SPINNAKER
- 

IN-MAST FURLING
- 

CLOSED COCKPIT
- 

STERN THRUSTER

DESIGN YOUR OWN ELAN

GELCOAT (HULL AND HULL DECORATION)

STANDARD

Signal White

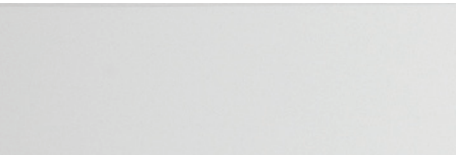

OPTIONAL

Navy Blue



OPTIONAL

Stone Grey



BIMINI & SPRAYHOOD & LAZY BAG

STANDARD

Oyster

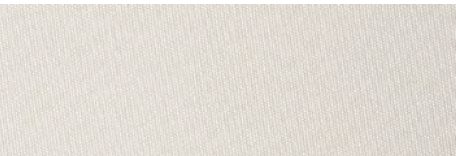

STANDARD

Navy Blue

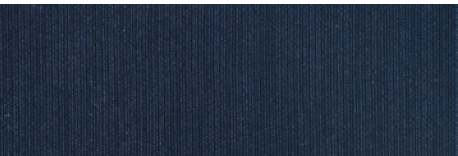

STANDARD

Midnight Black

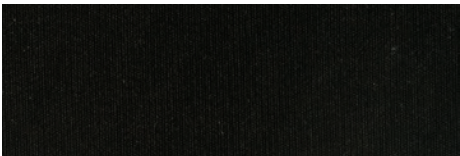

COCKPIT CUSHIONS

STANDARD

Light Grey



At Elan we are well aware that yacht personalization is very important to every customer and we want you to feel as comfortable as possible when sailing and enjoying vacation on your Elan or impression. With a wide selection of materials and color combinations we want to make your yacht as home-like as possible. Choosing between these materials and colors you can either make your interior modern or conventional. With strong, durable materials, your yacht will look magnificent for years to come.

FURNITURE WOOD

STANDARD

Blond Oak



OPTIONAL

Fjord Mahagony



OPTIONAL

Royal Teak

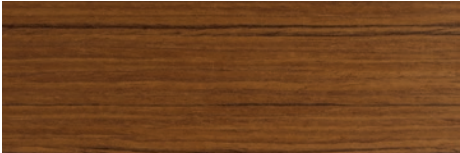

FLOOR

STANDARD

Wave Grey Style

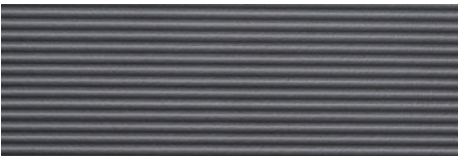

STANDARD

Wave Cream Style



STANDARD

Classic Stripes



OPTIONAL

Maple Grey Style



OPTIONAL

Maple Cream Style



UPHOLSTERY

STANDARD PORTOROSE

Cotton



OPTION ANCARANO



CABIN



OPTIONAL

Earth

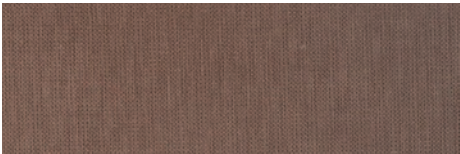
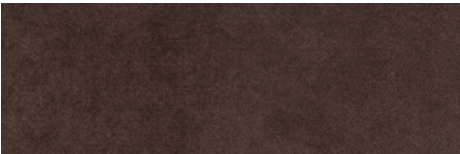

OPTIONAL

Ocean

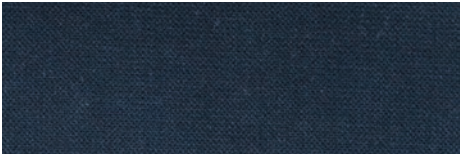
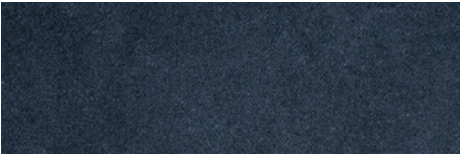
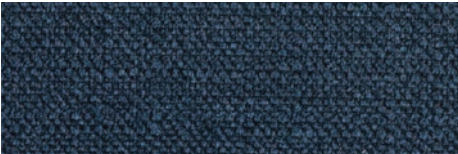

OPTIONAL

Sunset

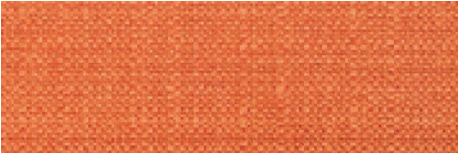

OPTIONAL

Lavender

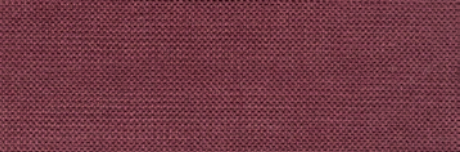
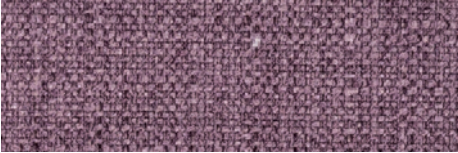



STANDARD EQUIPMENT



Sheets running under the deck.



Folding platform.



Fixed cockpit table.



Durable galley surface.



Additional berth in saloon.



Separate shower.

MAIN OPTIONALS



Gennaker bowsprit.



Solar pannels.



Teak deck.



Ambient lights.



Coffee machine.



Wine cellar.

PARTNERS

RIGGING, DECK EQUIPMENT



DECK EQUIPMENT



DECK EQUIPMENT



NAVIGATION AND COMMUNICATION



NAVIGATION AND COMMUNICATION



ENTERTAINMENT SYSTEMS



SAILS AND LAZY BAG



THE NEXT GENERATION OF SAILS

ENGINES AND PROPELLERS



FOLDING PROPELLERS



RUNNING RIGGING, ROPES



STEERING SYSTEMS



BIMINI, SPRAYHOOD



WINDLASS, DECK EQUIPMENT, BOWTHRUSTERS AND STERNTHRUSTERS



BOWTHRUSTERS AND STERNTHRUSTERS



STEERING WHEELS, CONSOLES, TILLERS, GANGWAYS



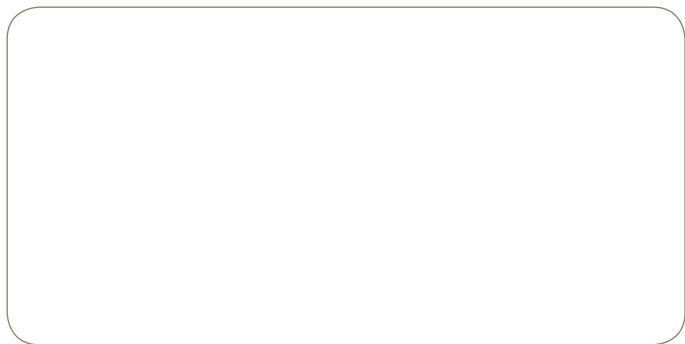





Photo by: Matija Klemenc, Jurij Korenc, Simon Plestenjak, Aljoša Rebolj, Miha Špende.

All measurements are approximate. This brochure is not contractual. Yachts depicted usually include extras not included in the standard package. Colours and materials can show up differently on printed matter.



elan

WWW.ELAN-YACHTS.COM

ELAN, D.O.O.

BEGUNJE 1,

4275 BEGUNJE NA GORENJSKEM, SLOVENIA

T: + 386 4 53 51 109, E: SAIL@ELAN.SI